

# ÖLÇÜ TEYİT FORMU

## Index / İçindekiler

1	TR	ENDÜSTRİYEL KAPI STANDART YATAKLAMA Ölçü Teyit Formu	1
2	EN	INDUSTRIAL DOOR STANDART LIFT Confirmation Form	2





## ENDÜSTRİYEL KAPI ÖLÇÜ TEYİT FORMU (STD) STANDART YATAKLAMALI

FİRMA İSMİ:

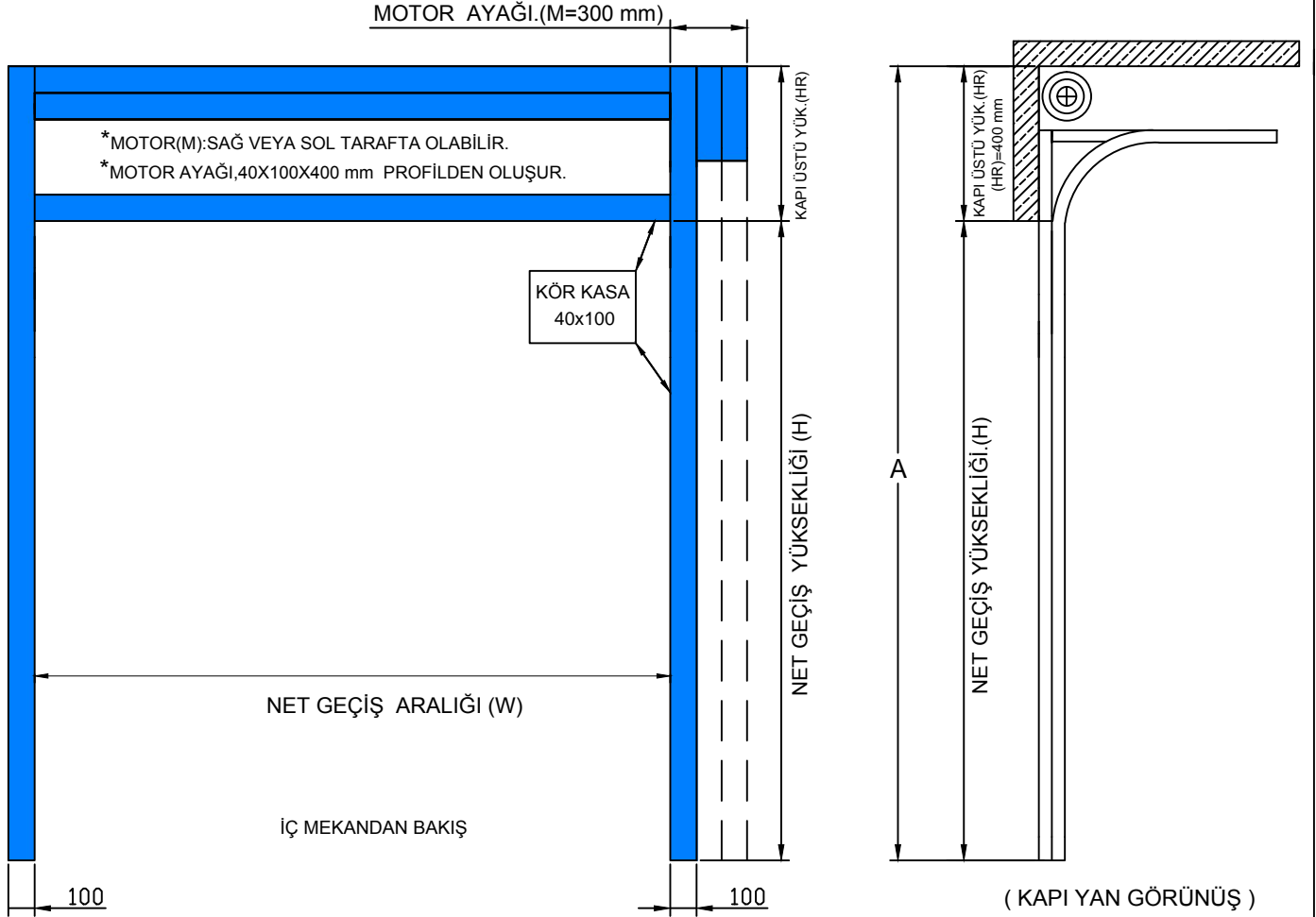

*SERVİS KAPISI	VAR	SAĞ	ORTA	SOL
*SERVİS KAPISI KONUMU İÇ MEKANDAN BAKILARAK BELİRTİLMELİDİR.				
PENCERE	END DİKDÖRTGEN	END OVAL	DAR DİKDÖRTGEN	
PENCERE KONUM				

PANEL TİPİ	ÇİZGİLİ	KASET Lİ	DÜZ
PANEL RENGİ	DIŞ		İÇ
	RAL		RAL
KAPI ADEDİ			

KAŞE/İMZA

--

NET GEÇİŞ ARALIĞI(W)		NET GEÇİŞ YÜKSEKLİĞİ(H)		KAPI ÜSTÜ YÜKSEKLİĞİ(HR)	
----------------------	--	-------------------------	--	--------------------------	--

DİĞER NOTLAR:



ÖLÇÜLER KÖR KASA İÇTEN İÇE ÖLÇÜLERİ OLMALI VE O ŞEKİLDE BELİRTİLMELİDİR.  
KAPI DÖNÜŞ KISMINI VE YATAKLAMA ALANINI ENGELLEYECEK ,KIRIŞ,BORU,ELEKTİRİK TAVASI VB.HİÇ BİRŞEY BULUNMAMALIDIR.  
İSTİSNALI DURUMLARDA TARAFIMIZA BİLDİRİLMESİ GEREKMEKTEDİR.YAY PAKETİ İÇİN (STD) STANDART YATAKLAMALI  
KAPILARDA 400 MM ,(HL) YÜKSEK YATAKLAMALI KAPILARDA 350 mm, (GYT) GİYOTİN KAPILARDA 350 mm GEREKLİDİR.



**INDUSTRIAL DOOR SIZE CONFIRMATION FORM  
(STD) STANDART LIFT**

COMPANY NAME: \_\_\_\_\_

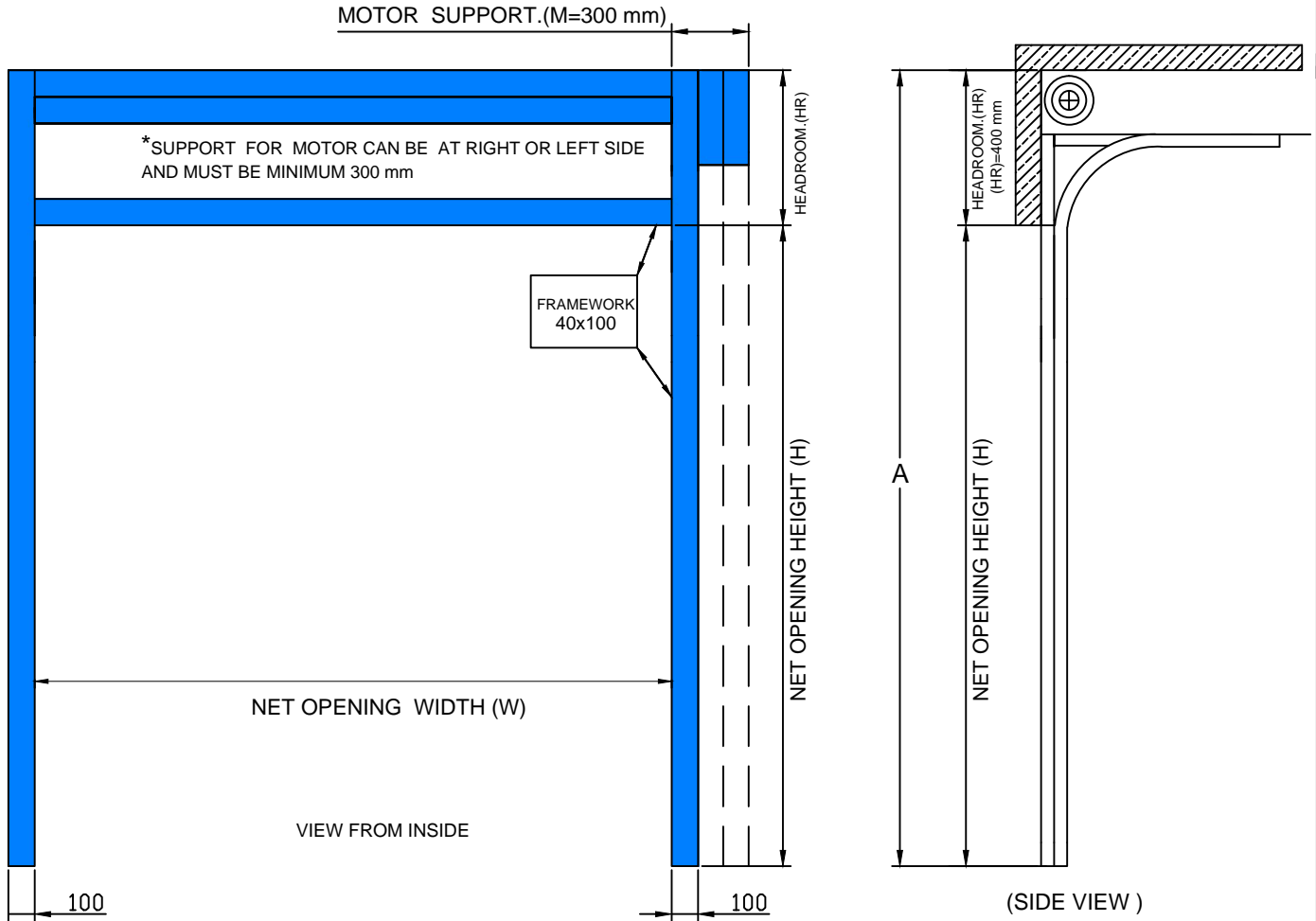

*PASS DOOR	YES	RIGHT	MIDDLE	LEFT	TYPE OF THE PANEL	RIBBED	CASSETTE	STRAIGHT	STAMP/SIGNATURE	
* POSITION OF THE PASS DOOR MUST BE INDICATED AS VIEW FROM INSIDE										
WINDOW	RECTANGULAR WINDOW	OVAL WINDOW	NARROW WINDOW			COLOR OF THE PANEL	OUTER			INNER
							RAL			RAL
POSITION OF THE WINDOW					NUMBER OF DOOR					

NET OPENING WIDTH(W)		NET OPENING HEIGHT(H)		HEADROOM(HR)	
----------------------	--	-----------------------	--	--------------	--

NOTES: \_\_\_\_\_

 **ALL DIMENSIONS MUST BE CLEAR AND NO OBSTACLE IS PERMITTED IN THE HEADROOM & SIDEROOMS. STD DOORS REQUIRE 400 mm, HL & VL REQUIRE 350 mm HEADROOM**

EN